



# 文件递交参考指南

## Guidelines for Document Submission

### 2025

<https://scedufund.sinchew.com.my/>

# STEP 1

## 网上登记 Online Registration

### 备注 Remark:

- a) 第一次登录者，需先注册成为会员。

First time user has to sign up as a member.

- b) 输入相关个人资料后，请按“注册”键。

Please click the “Sign Up” button once you have completed all relevant personal data.



### Applicant Registration

All Field is Required!

Full Name (English) :

Contact Number :   
*Example : 018-8888888*

IC Number

Email :

Reenter Email :

Password :

Reenter Password :

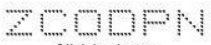
  
Click to change

Please enter the Captcha

I hereby consent that Media Chinese International Limited ("MCIL") and its subsidiaries ("the Group") may process (as defined in the Act) my personal data in accordance with the provisions of the Personal Data Protection Act 2010 (the "Act") and be retained

[Back to Main Page](#)

## 网上登记 Online Registration

### 备注 Remark:

- c) 成功启动帐户后，您的电脑将显示“登录”界面。

After successfully activated your account, the “Login” interface will be shown.



Please [download](#) the Submission Guidelines before applying

### Login

|                                     |   |                          |   |                      |   |                      |
|-------------------------------------|---|--------------------------|---|----------------------|---|----------------------|
| NRIC                                | : | <input type="text"/>     | - | <input type="text"/> | - | <input type="text"/> |
| Password                            | : | <input type="password"/> |   |                      |   |                      |
| <a href="#">Forgotten Password?</a> |   |                          |   |                      |   |                      |
| <a href="#">Login</a>               |   |                          |   |                      |   |                      |

[Back to Main Page](#)

# STEP 2

## 填妥电子申请表格

### Complete the E-Application Form

表格涵盖以下6个组别:

The form has 6 categories as follows:

1. 个人资料 Personal Data
2. 科系 Course
3. 教育程度 Educational Qualifications
4. 家庭背景 Detail of Family Background
5. 文件储存链接 Documents Storage URL
6. 确认呈交表格 Confirm Submit Form

歡迎您, [Name], 您已經成功登录。  
[修改密碼 Change Password] [登出 Logout]

My Account

- 個人資料 Personal Data
- 科系 Course
- 教育程度 Educational Qualifications
- 家庭背景 Detail of Family Background
- 文件儲存链接 Documents Storage URL
- 确认呈交表格 Confirm Submit Form

星洲日報教育基金  
Sin Chew Daily Education Fund

星洲日報  
SIN CHEW DAILY

個人資料 Personal Details :

(\* ) 必須填寫 - Mandatory fields must be filled in  
(#) 請務必填寫其中一項 Please fill in one of the fields

|  |   |
|--|---|
| * 姓名(如身份證所示)<br>Full Name (as shown in IC) : | Name(E) [Name]<br>Name(C) [Name]<br><small>(** If you are unable to input Chinese characters, please print the form and fill in the particulars.<br/>如無中文輸入法, 請在列印後自行填上。)</small> |
| * 新身份證號碼<br>New IC No. :                     | [IC No.]  |
| * 住宅地址<br>Home Address :                     | [Address]<br><small>(請勿填寫郵政信箱地址。<br/>Please do not fill in a P.O. Box address.)</small>   |
| * 郵政編號<br>Postcode :                         | [Postcode]  |
| * 城市<br>City :                               | [City]  |
| * 州屬   | [State]   |

## 填妥电子申请表格

### Complete the E-Application Form

#### 备注 Remark:

- 每页的资料输入齐全后，请务必按最下角的“Save”键。

Kindly press the 'Save' button at the bottom, once completed each page.

**Has any of your siblings ( brother(s) / sister(s)) benefited from other education funds?**

有 Yes  
 無 No

如有，請提供以下資料：  
If applicable, please provide the following information:

| 姓名<br>Name                 | 關係<br>Relationship   | 入學年份<br>Year<br>Admitted | 大學/學院<br>University/College | 科系<br>Course         | 獎學金贊助單位<br>Sponsorship Unit |
|----------------------------|----------------------|--------------------------|-----------------------------|----------------------|-----------------------------|
| 英:<br><input type="text"/> | <input type="text"/> | 至 to                     | <input type="text"/>        | <input type="text"/> | <input type="text"/>        |
| 中:<br><input type="text"/> |                      | <input type="text"/>     |                             |                      |                             |
| 英:<br><input type="text"/> | <input type="text"/> | 至 to                     | <input type="text"/>        | <input type="text"/> | <input type="text"/>        |
| 中:<br><input type="text"/> |                      | <input type="text"/>     |                             |                      |                             |
| 英:<br><input type="text"/> | <input type="text"/> | 至 to                     | <input type="text"/>        | <input type="text"/> | <input type="text"/>        |
| 中:<br><input type="text"/> |                      | <input type="text"/>     |                             |                      |                             |
| 英:<br><input type="text"/> | <input type="text"/> | 至 to                     | <input type="text"/>        | <input type="text"/> | <input type="text"/>        |
| 中:<br><input type="text"/> |                      | <input type="text"/>     |                             |                      |                             |

**\* 您的兄弟姐妹是否也同時申請此獎學金計劃？**  
**Have any of your siblings (brother/sister) applied for this Fund?**

有 Yes  
 無 No

## 填妥电子申请表格

### Complete the E-Application Form

#### 备注 Remark:

- 每页的资料输入齐全后，请务必按最下角的“Save”键。

Kindly press the 'Save' button at the bottom, once completed each page.

歡迎您, [ ] 您已經成功登錄。

**My Account** [修改密碼 Change Password] [登出 Logout]

個人資料 Personal Data   **科系 Course**   教育程度 Educational Qualifications   家庭背景 Detail of Family Background   文件儲存連接 Documents Storage URL

確認呈交表格 Confirm Submit Form

**星洲日報教育基金**  
Sin Chew Daily Education Fund

**星洲日報**  
SIN CHEW DAILY

每位申請者可申請一或兩個科系，若申請兩個科系，條件如下：  
Each applicant is eligible to apply for 1 or 2 courses. If applying 2 courses, the criteria are as follows:

- 同一所大專的兩個不同科系 2 different courses from 1 university/college

或 or

- 兩所不同大專的個別科系 1 course from 2 different universities/colleges

**第一选项 First Choice:**

(\* ) 必須填寫 - Mandatory fields must be filled in

\* 本人以下列成績提出申請 This application is based on the following result (Please choose an option):

- 馬來西亞教育文憑 (SPM)
- 馬來西亞高級學校文憑 (STPM)
- 獨中統考成績(UEC)
- A 水平 (A-Level)
- 其他學歷資格 (Other Academic Qualifications): [ ]

## 填妥电子申请表格

### Complete the E-Application Form

学术资格  
选项  
Academic  
Qualification  
Options

#### 第一选项 First Choice:

(\* ) 必須填寫 - Mandatory fields must be filled in

\* 本人以下列成績提出申請 This application is based on the following result (Please choose an option) :

- 馬來西亞教育文憑 (SPM)
- 馬來西亞高級學校文憑 (STPM)
- 獨中統考成績 (UEC)
- A 水平 (A-Level)
- 其他學歷資格 (Other Academic Qualifications) :

(例子: *Diploma in Accounting / Foundation in Science*)

为避免发生网络兼容性问题而导致此栏目的资料遗失, 请在完成选项后按 SAVE 键。

To Prevent loss of data due to network compatibility issues, please press the SAVE button after completing this

課程 Course :

\* 大學/學院名稱

Name of University/College :

\* 申請科系

Course Applied For :

## 填妥电子申请表

### Complete the E-Application Form

#### 备注 Remark:

- 若申请者点选的学术资格是SPM, 系统将自动设定不显示学士 (Degree) 课程选项, 因为SPM 毕业生还未达到申请学士课程的学术资格。

If the academic qualification selected by the applicant is SPM, the system will automatically set not to display the Degree program option, as SPM graduates do not meet the academic qualifications for applying for a Degree program.

**第一选项 First Choice:**

(\* ) 必須填寫 - Mandatory fields must be filled in

\* 本人以下列成績提出申請 This application is based on the following result (Please choose an option):

馬來西亞教育文憑 (SPM)

馬來西亞高級學校文憑 (STPM)

獨中統考成績 (UEC)

A 水平 (A-Level)

其他學歷資格 (Other Academic Qualifications):

(例子: Diploma in Accounting / Foundation in Science)

为避免发生网络兼容性问题而导致此栏目的资料遗失, 请在完成选项后按 SAVE 键。  
To Prevent loss of data due to network compatibility issues, please press the SAVE button after completing this

**課程 Course:**

\* 大學/學院名稱  
Name of University/College:

\* 申請科系  
Course Applied For:

学术资格  
选项  
Academic  
Qualification  
Options

点选了学术  
资格后, 系  
统才会显示  
课程选项

Course  
options will  
not appear  
until  
academic  
qualification  
has been  
selected



## 填妥电子申请表

### Complete the E-Application Form

每位申请者可申请一或两个科系，  
若申请两个科系，条件如下：

Each applicant is eligible to apply for 1  
or 2 courses. If applying 2 courses, the  
criteria are as follows:

- 同一所大专的两个不同科系  
2 different courses from 1  
university/college

或 or

- 两所不同大专的个别科系  
1 course from 2 different  
universities/colleges

#### 第一选项 First Choice:

(\* ) 必須填寫 - Mandatory fields must be filled in

\* 本人以下列成績提出申請 This application is based on the following result (Please choose an option):

- 馬來西亞教育文憑 (SPM)
- 馬來西亞高級學校文憑 (STPM)
- 獨中統考成績 (UEC)
- A 水平 (A-Level)
- 其他學歷資格 (Other Academic Qualifications):

(例子: Diploma in Accounting / Foundation in Science)

为避免发生网络兼容性问题而导致此栏目的资料遗失, 请在完成选项后按 SAVE 键。

To Prevent loss of data due to network compatibility issues, please press the SAVE button after completing this

課程 Course:

\* 大學/學院名稱

Name of University/College: 已選大學/學院: University of Nottingham  
University/College: University of Nottingham

\* 申請科系

已選科系: BSc (Hons) Biomedical Sciences  
Course Applied For: BEng (Hons) / MEng (Hons) Mechanical Engineering

Save

#### 第二选项 Second Choice:

(\* ) 必須填寫 - Mandatory fields must be filled in

\* 本人以下列成績提出申請 This application is based on the following result (Please choose an option):

- 馬來西亞教育文憑 (SPM)
- 馬來西亞高級學校文憑 (STPM)
- 獨中統考成績 (UEC)
- A 水平 (A-Level)
- 其他學歷資格 (Other Academic Qualifications):

(例子: Diploma in Accounting / Foundation in Science)

为避免发生网络兼容性问题而导致此栏目的资料遗失, 请在完成选项后按 SAVE 键。

To Prevent loss of data due to network compatibility issues, please press the SAVE button after completing this

課程 Course:

\* 大學/學院名

稱 Name of University/College: 已選大學/學院: Multimedia University (MMU)  
University/College: Multimedia University (MMU)

\* 申請科系

已選科系: Any Bachelor of Information Technology and Computer Science: Bachelor of Computer Science / Information System / Data Communication and Networking / Business Intelligence and Analytics / Artificial Intelligence / Security Technology / Bioinformatics (Inclusive Foundation Programme)  
Course Applied For: Any Bachelor of Information Technology and Computer Science: Bachelor of Computer Science

Save

Option 1  
選項一

Option 2  
選項二

## 填妥电子申请表

### Complete the E-Application Form

- 一旦完成课程选项程序，并按“Save”键后，电脑界面会显示**蓝色字体**。意味着你申请的大专及科系已成功存档。

The computer interface will show **blue font** once you have completed the course selection procedure, and pressed the “Save” button. It means that the university/college and course you applied for has been successfully saved.

#### 第一选项 First Choice:

(\* ) 必須填寫 - Mandatory fields must be filled in

\* 本人以下列成績提出申請 This application is based on the following result (Please choose an option) :

馬來西亞高級學校文憑 (STPM)

A水平 (A-Level)

其他學歷資格 (Other Academic Qualifications) :

(例子: *Diploma in Accounting / Foundation in Science*)

为避免发生网络兼容性问题而导致此栏目的资料遗失，请在完成选项后按 SAVE 键。

To Prevent loss of data due to network compatibility issues, please press the SAVE button after completing this

#### 課程 Course :

|  |  |
|--|--|
| * 大學/學院名稱<br>Name of<br>University/College : | 已选大学/学院 Selected University/College >> UCSI University<br>UCSI University                |
| * 申請科系<br>Course Applied For :               | 已选科系 Selected Course >> Diploma in Information Systems<br>Diploma in Information Systems |

Save

蓝色字体  
Blue Font

## 填妥电子申请表格

### Complete the E-Application Form

#### 备注 Remark:

- 每页的资料输入齐全后，请务必按最下角的“Save”键。

Kindly press the 'Save' button at the bottom, once completed each page.

歡迎您, lock@sinchew.com.my, 您已經成功登錄。

**My Account** [修改密碼 Change Password] [登出 Logout]

個人資料  
Personal Data

科系  
Course

教育程度  
Educational Qualifications

家庭背景  
Detail of Family Background

文件儲存鏈接  
Documents  
Storage URL

確認呈交表格  
Confirm Submit  
Form

**星洲日報教育基金**  
**Sin Chew Daily**  
**Education Fund**

  
SIN CHEW DAILY

(\*) 必須填寫 - Mandatory fields must be filled in  
(#) 請務必填寫其中一項 Please fill in one of the fields

家庭狀況 / Family Status: 雙親 Parents

**家庭背景 Details of Family Background :**

**# 父親 Father**

|                   |  |
|-------------------|--|
| 姓名<br>Full Name : | (中 Chinese) <input style="width: 90%;" type="text"/><br>(英 English) <input style="width: 90%;" type="text"/> |
| 身份證號碼<br>IC No.   | (新 New) <input style="width: 90%;" type="text"/><br>(舊 Old) <input style="width: 90%;" type="text"/>         |
| 年齡 / Age :        | <input style="width: 90%;" type="text"/>   |
| 住宅地址              | <input style="width: 90%; height: 30px;" type="text"/>   |

(\*\* If you are unable to input Chinese characters, please print the form and fill in the particulars. 如無中文輸入法, 請在列印後自行填上。)

個人資料  
Personal Data科系  
Course教育程度  
Educational Qualifications家庭背景  
Detail of Family Background文件儲存链接  
Documents  
Storage URL确认呈交表格  
Confirm Submit  
Form

# STEP 3

## 文件储存链接

### Documents Storage URL

1. 请先把列号**1至8**的文件准备好，然后上载到个人的谷歌云端硬盘，并将文件夹设为**Anyone with the link**。列号9的文件（电子申请表格）待完成签名程序后才上载。

Please prepare the **documents of No. 1 to 8**, then upload to your personal Google Drive, and set the folder to "Anyone with the link". The document of No. 9 (E-application form) will not be uploaded until the signing procedure has been completed.

2. 完成上载列号**1至8**的文件到谷歌云端硬盘后，把相关链接输入右边的空格。

After uploading the documents of No. 1 to 8 to Google Drive, enter the relevant link into the column on the right.

星洲日報教育基金  
Sin Chew Daily Education Fund星洲日報  
SIN CHEW DAILY

请把以下文件扫描后，上载到谷歌云端硬盘，并将文件夹设为 Anyone with the link.  
Please scan the following files, upload them into Google Drive, and change folder setting to Anyone with the link.

备注：在上载文件前，请务必下载“递交文件图片参考”。（[点击下载PDF](#)，5.31MB）  
Remark: Before uploading your documents, please download the "Pictures reference for documents submission". ([Click here to download PDF](#), 5.31MB)

1. 个人近照（护照尺寸） / Recent Personal Photo (Passport size)
2. 身分证（正反两面同在一張A4纸） / MyKad (front and back sides on one A4 paper)
3. 报生纸 / Birth Certificate
4. 学术成绩证书或相关文凭 / Academic Results Certificates or relevant documents (e.g. SPM, STPM, UEC, A Level, Foundation or Diploma & etc.)
5. 课外活动证书（学术、运动、制服团体等） / Extra-Curricular Activities Certificates (academic, sports, uniformed groups, etc.)
6. 财务状况证明文件 / Supporting documents on Financial status (e.g. EA Form, Payslip, Income Tax Form or Salary Acknowledgement Letter)
7. 支出证明文件（最近一个月电费单、水费单、房租收据证明或租约） / Supporting documents on Expenditures (latest month electricity bill, water bill and house rental Receipt or tenancy agreement)
8. 其他相关文件（离婚证书、死亡证书或残障证件复印本） / Other relevant documents (photocopy of divorce certificate, death certificate or OKU card)
9. 星洲日報教育基金申请表格（已完成电子签名） / Sin Chew Daily Education Fund Application Form (electronic signature completed)  
欲取得星洲日報教育基金申请表格，需先浏览“确认呈交表格”页面，点击其右下角的“呈交表格”键，之后点击“SAVE PDF”（申请表格）。接着再打开电子申请表格并完成签名程序，才另外上载到谷歌云端硬盘。 / To obtain the Sin Chew Daily Education Fund Application Form mentioned in item 9 above, you must first browse the "Confirm Submit Form" page. Click the "Submit Form" button at the bottom right, then select "SAVE PDF" (Application Form). Next, open the electronic application form, complete the signing process, and then upload it separately to Google Drive.

请输入谷歌云端硬盘链接  
Please enter Google Drive URL:

[https://drive.google.com/file/d/1gBG8p4u0AznIvQPjipTv\\_9p1PdIx\\_bAcP/view?usp=drive\\_link](https://drive.google.com/file/d/1gBG8p4u0AznIvQPjipTv_9p1PdIx_bAcP/view?usp=drive_link)

## 文件储存链接

### Documents Storage URL

#### 提醒 REMINDER:

- 在输入谷歌云端硬盘链接前，请务必先参阅第21至23页的附录：“电子文件上传指南”。
- Please refer to the Appendix: “E-Document Upload Guidelines” on page 21 to 23 before entering the Google Drive URL.

列号9的文件待完成签名程序后才上传  
Document of No. 9 (E-application form)  
will not be uploaded until the signing  
procedure has been completed

备注：在上载文件前，请务必下载“文件递交参考指南”。( [点击下载PDF](#) , 5.71MB)  
Remark: Before uploading your documents, please download the “Guidelines for Document Submission” . ( [Click here to download PDF](#) , 5.71MB)

1. 个人近照 (护照尺寸) / Recent Personal Photo (Passport size)
2. 身分证 (正反两面同在一张A4纸) / MyKad (front and back sides on one A4 paper)
3. 报生纸 / Birth Certificate
4. 学术成绩证书或相关文凭 / Academic Results Certificates or relevant documents (e.g. SPM, STPM, UEC, A Level, Foundation or Diploma & etc.)
5. 课外活动证书 (学术、运动、制服团体等) / Extra-Curricular Activities Certificates (academic, sports, uniformed groups, etc.)
6. 财务状况证明文件 / Supporting documents on Financial status (e.g. EA Form, Payslip, Income Tax Form or Salary Acknowledgement Letter)
7. 支出证明文件 (最近一个月电费单、水费单、房租收据证明或租约) / Supporting documents on Expenditures (latest month electricity bill, water bill and house rental Receipt or tenancy agreement)
8. 其他相关文件 (离婚证书、死亡证书或残障证件复印件) / Other relevant documents (photocopy of divorce certificate, death certificate or OKU card)

9. 星洲日报教育基金申请表 (已完成电子签名) / Sin Chew Daily Education Fund Application Form (electronic signature completed)  
欲取得星洲日报教育基金申请表，需先浏览“确认呈交表格”页面，点击其右下角的“呈交表格”键，之后点击“SAVE PDF” (申请表)。接着再打开电子申请表并完成签名程序，才另外上载到谷歌云端硬盘。 / To obtain the Sin Chew Daily Education Fund Application Form mentioned in item 9 above, you must first browse the “Confirm Submit Form” page. Click the “Submit Form” button at the bottom right, then select “SAVE PDF” (Application Form). Next, open the electronic application form, complete the signing process, and then upload it separately to Google Drive.

请输入谷歌云端硬盘链接  
Please enter Google Drive URL:

[https://drive.google.com/file/d/1gB68p4u0AznIvQPjipTv\\_9p1PdNxbAcP/view?usp=drive\\_link](https://drive.google.com/file/d/1gB68p4u0AznIvQPjipTv_9p1PdNxbAcP/view?usp=drive_link)

Save

谷歌云端硬盘  
连接  
Google Drive  
URL



# STEP 4

## 确认呈交表格

### Confirm Submit Form

- 当“个人资料”、“科系”、“教育程度”、“家庭背景”和“文件储存链接”页面的资料填妥和存档后，“确认呈交表格”页面将出现6个“已完成”字眼。

The “Confirm Submit Form” page will show 6 “Completed” wordings, once the data of the “Personal Data”, “Course”, “Educational Qualifications”, “Detail of Family Background” and “Documents Storage URL” page have been completely *filled in* and saved.

- 请按“Save PDF”键，把电子申请表存为PDF档。

To save the E-Application Form in PDF format, please click the “Save PDF” button.

歡迎您 [ ] 您已經成功登錄。  
[修改密碼 Change Password] [登出 Logout]

My Account

個人資料 Personal Data    科系 Course    教育程度 Educational Qualifications    家庭背景 Detail of Family Background    文件儲存链接 Documents Storage URL

确认呈交表格 Confirm Submit Form

星洲日報教育基金  
Sin Chew Daily  
Education Fund

星洲日報  
SIN CHEW DAILY

呈交表格  
Submit Form

|                                   |                 |
|-----------------------------------|-----------------|
| 個人資料狀況 Personal Data status :     | (已完成 Completed) |
| 首選科系 First Course status :        | (已完成 Completed) |
| 次選科系 Second Course status :       | (已完成 Completed) |
| 教育程度 Educational Qualifications : | (已完成 Completed) |
| 其他 Other :                        | (已完成 Completed) |
| 文件儲存链接 Documents Storage URL :    | (已完成 Completed) |

呈交表格 Submit Form

## 确认呈交表格 Confirm Submit Form

请务必把已存档的电子申请表格PDF文档（也就是第12页提及的列号9文件）上载到你之前创建的谷歌云端硬盘。

Please make sure to upload the E-Application Form PDF format (i.e. Document No. 9 mentioned on Page 12) to the Google Drive you created earlier.

### SIN CHEW DAILY EDUCATION FUND 2025 (FOR OFFICE USED)

Applicant name:   
Application Code: 0004

This application is based on the following result :  
stpm

#### 1st Choice

**UCSI University (KL Campus)**

Course No : UCSI01-03

Course name: Foundation in Arts & BCA (Hons) 3D Animation Design

#### 2nd Choice

**HELP University**

Course No : HELP10-01

Course name: Foundation in Arts/ Science leading to Bachelor of Tourism Management (Honours)

---

**Remark (to be filled in by College/University after the interview):**

Awarded

Reserved Candidates

(1st Reserved/ 2nd Reserved/ 3rd Reserved/ 4th Reserved)

Disqualified

(Please state a reason, example: Failed to attend the interview)

---

KIV

Others: \_\_\_\_\_

Signed by the interviewers from the College/University:

\_\_\_\_\_

Interview Date: \_\_\_\_\_

Name:

Designation:

# STEP 5

填妥并签署电子申请表格及提交附件

Fill and sign the E-Application Form, and submission of relevant documents

- 开启 **Adobe Acrobat Reader**，以填妥并签署电子申请表格最后一页的空栏。

Open **Adobe Acrobat Reader** to complete and sign the blank fields on the last page of the E-Application Form.

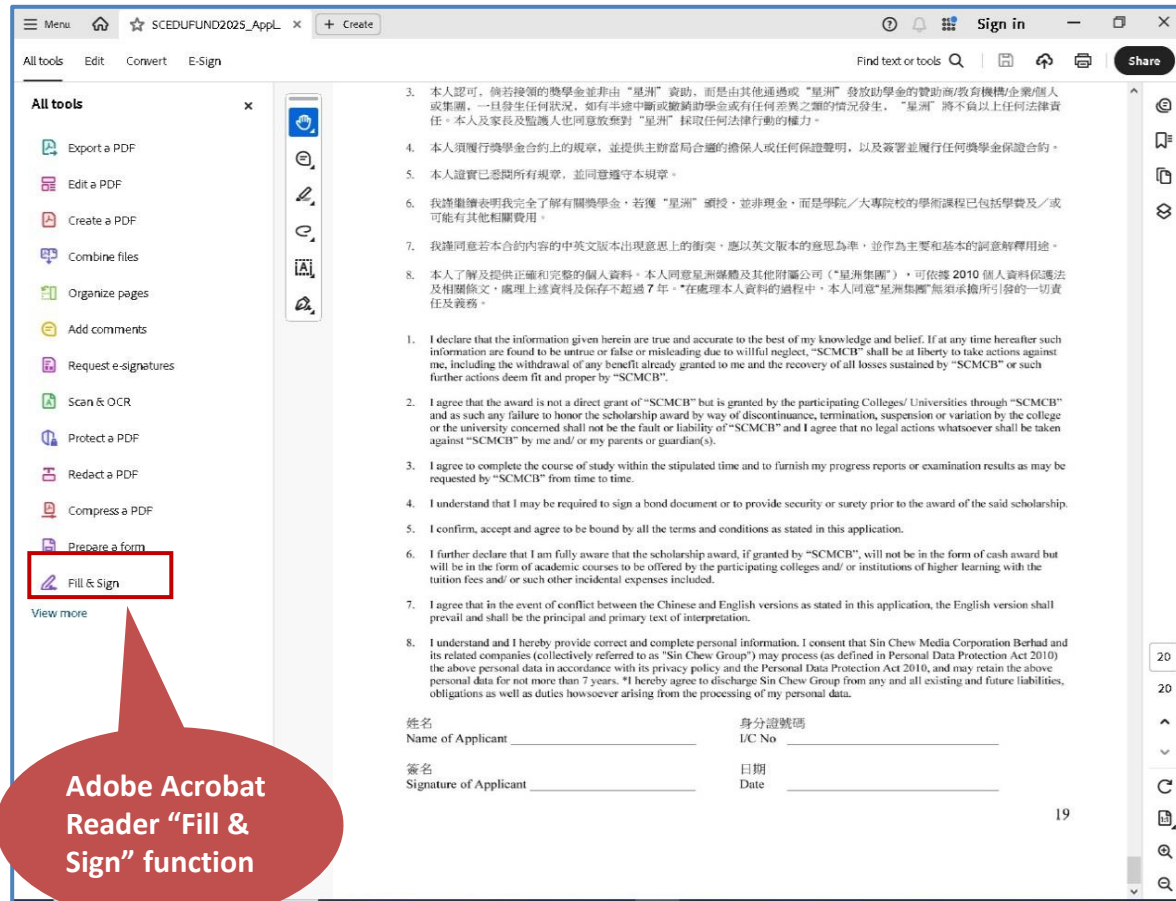



## 填妥并签署电子申请表格及提交附件

## Fill and sign the E-Application Form, and submission of relevant documents

- 使用Adobe Acrobat Reader的Fill and Sign yourself功能，完成电子签名程序。

Use the “Fill and Sign yourself” function of Adobe Acrobat Reader to complete the electronic signature process

The screenshot displays the Adobe Acrobat Reader interface for an e-signature process. The left sidebar shows the 'E-Sign' tool with the 'Add signature' button highlighted by a red circle and a callout bubble labeled '2. Add Signature'. The main document area contains a form with the following fields:

|                              |                |                 |                |
|------------------------------|----------------|-----------------|----------------|
| 姓名<br>Name of Applicant      | Park Min Young | 身分證號碼<br>LIC No | 010909-09-9998 |
| 簽名<br>Signature of Applicant |                | 日期<br>Date      | 1.4.2025       |

The document also includes a list of terms and conditions in both Chinese and English, starting with '本人認可，倘若獲頒的獎學金並非由“星洲”資助...' and 'I declare that the information given herein are true and accurate to the best of my knowledge and belief...'. A 'Free trial' button is visible at the bottom left of the interface.

1. Complete the “Fill & Sign” function

填妥并签署电子申请表格及提交附件

**Fill and sign the E-Application Form, and submission of relevant documents**

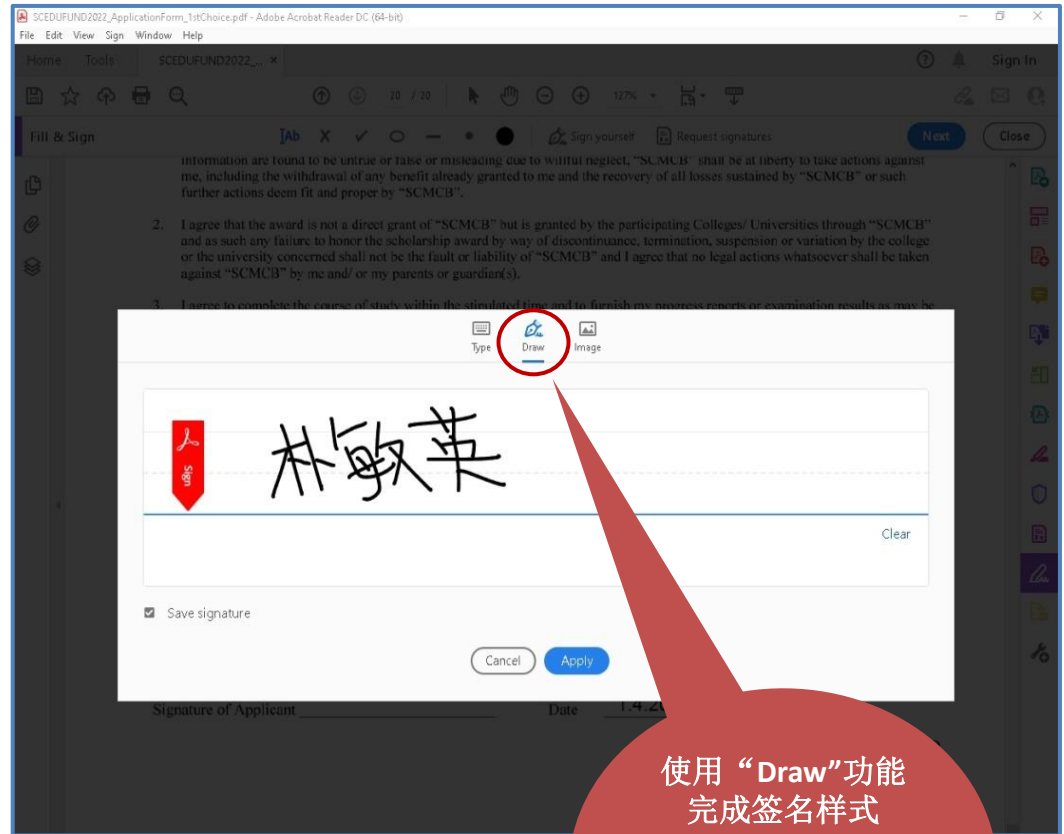

## 填妥并签署电子申请表格及提交附件

## Fill and sign the E-Application Form, and submission of relevant documents

将签名样式拖到相关的空栏  
Drag the signature to the appropriate column

签名放置完成  
Signature placement done

information are found to be untrue or false or misleading due to willful neglect, "SCMCB" shall be at liberty to take actions against me, including the withdrawal of any benefit already granted to me and the recovery of all losses sustained by "SCMCB" or such further actions deem fit and proper by "SCMCB".

2. I agree that the award is not a direct grant of "SCMCB" but is granted by the participating Colleges/ Universities through "SCMCB" and as such any failure to honor the scholarship award by way of discontinuance, termination, suspension or variation by the college or the university concerned shall not be the fault or liability of "SCMCB" and I agree that no legal actions whatsoever shall be taken against "SCMCB" by me and/ or my parents or guardian(s).
3. I agree to complete the course of study within the stipulated time and to furnish my progress reports or examination results as may be requested by "SCMCB" from time to time.
4. I understand that I may be required to sign a bond document or to provide security or surety prior to the award of the said scholarship.
5. I confirm, accept and agree to be bound by all the terms and conditions as stated in this application.
6. I further declare that I am fully aware that the scholarship award, if granted by "SCMCB", will not be in the form of cash award but will be in the form of academic courses to be offered by the participating colleges and/ or institutions of higher learning with the tuition fees and/ or such other incidental expenses included.
7. I agree that in the event of conflict between the Chinese and English versions as stated in this application, the English version shall prevail and shall be the principal and primary text of interpretation.
8. I understand and I hereby provide correct and complete personal information. I consent that Sin Chew Media Corporation Berhad and its related companies (collectively referred to as "Sin Chew Group") may process (as defined in Personal Data Protection Act 2010) the above personal data in accordance with its privacy policy and the Personal Data Protection Act 2010, and may retain the above personal data for not more than 7 years. \*I hereby agree to discharge Sin Chew Group from any and all existing and future liabilities, obligations as well as duties howsoever arising from the processing of my personal data.

|                              |                |                 |                |
|------------------------------|----------------|-----------------|----------------|
| 姓名<br>Name of Applicant      | Park Min Young | 身分證號碼<br>I/C No | 990101-01-0001 |
| 簽名<br>Signature of Applicant |                | 日期<br>Date      | 1.4.2022       |

information are found to be untrue or false or misleading due to willful neglect, "SCMCB" shall be at liberty to take actions against me, including the withdrawal of any benefit already granted to me and the recovery of all losses sustained by "SCMCB" or such further actions deem fit and proper by "SCMCB".

2. I agree that the award is not a direct grant of "SCMCB" but is granted by the participating Colleges/ Universities through "SCMCB" and as such any failure to honor the scholarship award by way of discontinuance, termination, suspension or variation by the college or the university concerned shall not be the fault or liability of "SCMCB" and I agree that no legal actions whatsoever shall be taken against "SCMCB" by me and/ or my parents or guardian(s).
3. I agree to complete the course of study within the stipulated time and to furnish my progress reports or examination results as may be requested by "SCMCB" from time to time.
4. I understand that I may be required to sign a bond document or to provide security or surety prior to the award of the said scholarship.
5. I confirm, accept and agree to be bound by all the terms and conditions as stated in this application.
6. I further declare that I am fully aware that the scholarship award, if granted by "SCMCB", will not be in the form of cash award but will be in the form of academic courses to be offered by the participating colleges and/ or institutions of higher learning with the tuition fees and/ or such other incidental expenses included.
7. I agree that in the event of conflict between the Chinese and English versions as stated in this application, the English version shall prevail and shall be the principal and primary text of interpretation.
8. I understand and I hereby provide correct and complete personal information. I consent that Sin Chew Media Corporation Berhad and its related companies (collectively referred to as "Sin Chew Group") may process (as defined in Personal Data Protection Act 2010) the above personal data in accordance with its privacy policy and the Personal Data Protection Act 2010, and may retain the above personal data for not more than 7 years. \*I hereby agree to discharge Sin Chew Group from any and all existing and future liabilities, obligations as well as duties howsoever arising from the processing of my personal data.

|                              |                |                 |                |
|------------------------------|----------------|-----------------|----------------|
| 姓名<br>Name of Applicant      | Park Min Young | 身分證號碼<br>I/C No | 990101-01-0001 |
| 簽名<br>Signature of Applicant |                | 日期<br>Date      | 1.4.2022       |

填妥并签署电子申请表格及提交附件

## Fill and sign the E-Application Form, and submission of relevant documents

### 备注 Remark:

- 申请者存档已签好名的申请表格时，请按以下格式命名：

**When the applicant saves the signed application form, please name it in the following format:**

学生名字.pdf（例如：Tan Ai Ling.pdf）

### SIN CHEW DAILY EDUCATION FUND 2025 (FOR OFFICE USED)

Applicant name:   
Application Code: 0004

This application is based on the following result :  
stpm

#### 1st Choice

UCSI University (KL Campus)  
Course No : UCSI01-03  
Course name: Foundation in Arts & BCA (Hons) 3D Animation Design

#### 2nd Choice

HELP University  
Course No : HELP10-01  
Course name: Foundation in Arts/ Science leading to Bachelor of Tourism Management (Honours)

---

Remark (to be filled in by College/University after the interview):

Awarded

Reserved Candidates

(1st Reserved/ 2nd Reserved/ 3rd Reserved/ 4th Reserved)

Disqualified

(Please state a reason, example: Failed to attend the interview)

---

KIV

Others: \_\_\_\_\_

Signed by the interviewers from the College/University:

\_\_\_\_\_

Interview Date: \_\_\_\_\_

Name:

Designation:

电子文件上传指南  
E-Document Upload  
Guidelines

# STEP 1

- 把已完成签名的电子申请表格（PDF档），连同上述相关文件上载到之前创建的谷歌云端硬盘文件夹内。

Upload the SIGNED E-Application Form (PDF format), along with the relevant documents above, to the Google Drive folder you created earlier.

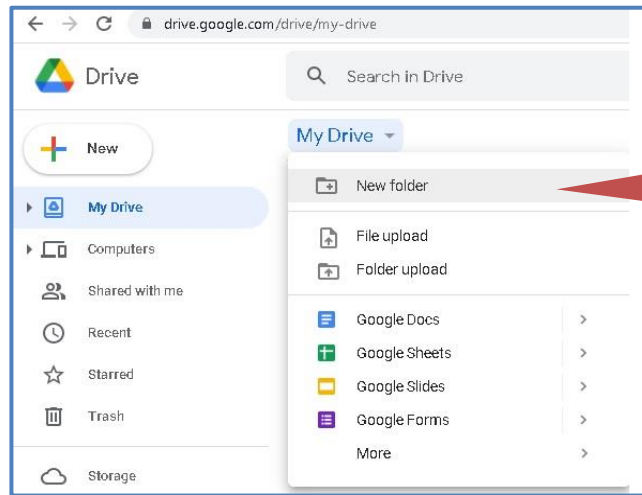

在谷歌云端硬盘  
创建新的文件夹  
Create a new  
folder in Google  
Drive

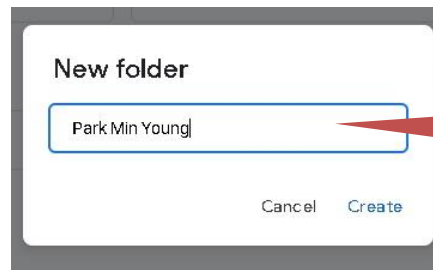

文件夹以申请者英文  
全文名命名  
The folder is named  
after the applicant's  
full English name

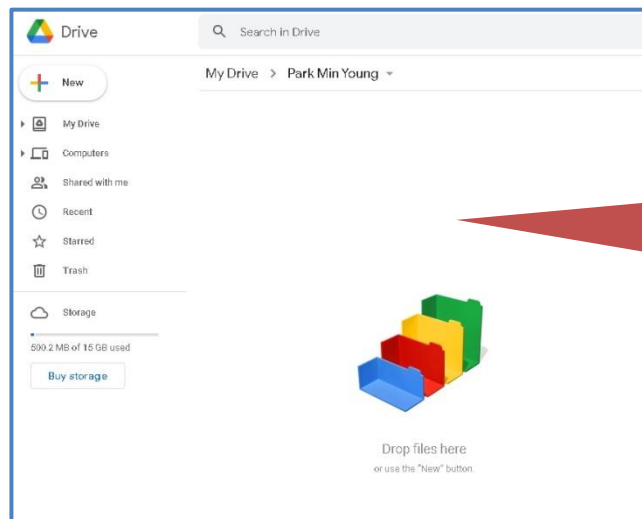

把所有相关文件拖  
入文件夹内  
Drag and drop all  
relevant files into  
the folder

# STEP 2

- 确保第11页列明的所有文件都已上载到你的谷歌云端硬盘文件夹内。

Make sure all files listed on page 11 are uploaded to your Google Drive folder.

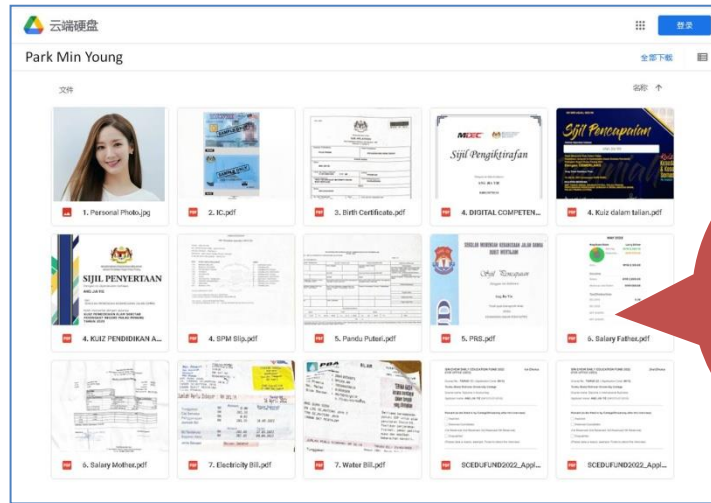

确保所有的文件都已完整上传至文件夹  
Make sure all documents are completely uploaded to the folder

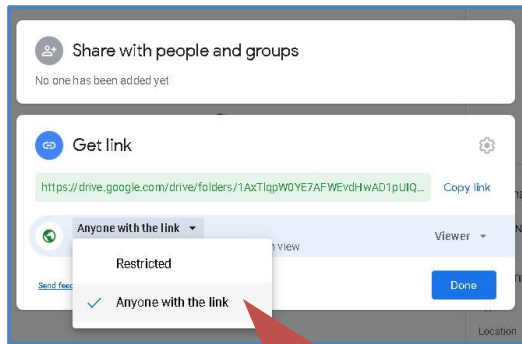

把文件夹设置改为“Anyone with the link”  
Change the folder setting to "Anyone with the link"

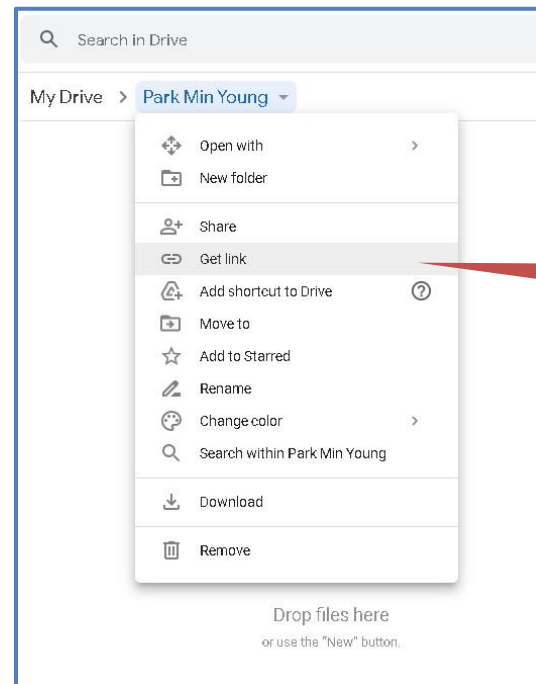

点击“Get link”  
Click “Get link”

若文件夹设为“Restricted”，无法打开，申请表格将自动作废。  
If the folder is set to "Restricted" and unable to access, the application form will be automatically invalidated.

附件指南  
Appendix Guidelines



## Item No. 2 (Identity Card)



Saya sahkan bahawa ini adalah salinan yang benar daripada surat asal yang telah ditunjukkan kepada saya

PENOLONG KANAN HAL EHWAL MURID  
SMJK

- The documents attached for item 2 to 13 must be a “truly certified copy”.  
第2至第13项之附件须是“核证影印本”。

核证文件副本可以找学校校长或老师、村长、国州议员、宣誓官或父母的雇主。

“Truly Certified Copy” can be certified by Headmaster, Teacher, Penghulu, Member of Parliament or State Assemblymen, Commissioner for Oaths or Employer.

## Item No. 3 (Birth Certificate)

- The documents attached for item 2 to 13 must be a “truly certified copy”.

第2至第13项之附件须是“核证影印本”。

NO [REDACTED]

  
**SJIL KELAHIRAN** J [REDACTED]  
 BORANG A  
 NEGERI-NEGERI TANAH MELAYU  
 [Salinan Untuk Pemaklum]  
 Akta Pendaftaran Kelahiran dan Kematian, 1957  
 [Sekyen 14; Auran 7]

Kawasan Pendaftaran: SELANGOR DARSAN  
 Kawasan Kecil: DAUN TANJANG

Name Penuh Kanak-kanak: [REDACTED]  
 Tempat Kelahiran: [REDACTED] Tarikh dan Waktu Kelahiran: [REDACTED] Jantina: SITI PERDAPUAN

Name Bapa: [REDACTED]  
 Nombor Kad Pengenalan Bapa: [REDACTED] Warna: BIRU  
 Lain-lain Dokumen Pengenalan Bapa: UJDA  
 Pekerjaan Bapa: [REDACTED]  
 Keturunan Bapa: CINA

Name Ibu Sebelum Kahwin: [REDACTED] Umur: 21 th  
 Nombor Kad Pengenalan Ibu: [REDACTED] Warna: BIRU Keturunan: CINA  
 Lain-lain Dokumen Pengenalan Ibu: UJDA  
 Tempat Tinggal Ibu yang biasa: [REDACTED]

Tarikh Pendaftaran: [REDACTED]

Disahkan bahawa cabutan di atas ialah salinan benar bagi catatan dalam Daftar Kelahiran

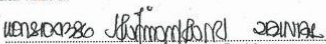
  
 Nama, Tarikh dan Jawatan Pendaftaran: [REDACTED]  
 [REDACTED]

Saya sahkan bahawa ini adalah salinan yang benar daripada surat asal yang telah ditunjukkan kepada saya

  
 [REDACTED]  
 PENOLONG KANAN HAL EHWAL MURID  
 SMJK [REDACTED]

## Item No. 4 (SPM slip)

- The documents attached for item 2 to 13 must be a “truly certified copy”.

第2至第13项之附件须是“核证影印本”。

LEMBAGA PEPERIKSAAN  
KEMENTERIAN PELAJARAN MALAYSIA  
SIJIL PELAJARAN MALAYSIA 2010

(RPN: 66666)

LEMBAGA PEPERIKSAAN  
KEMENTERIAN PELAJARAN MALAYSIA  
SIJIL PELAJARAN MALAYSIA 2010

(LP/KOM.6) Fig. 1/2010

NAMA : [REDACTED]  
NO. K/P : [REDACTED]  
SEKOLAH : SMJK [REDACTED]

ANGKA GILIRAN : [REDACTED]  
KOD DAFTAR : B JEN. DAHULU: 0

| KDD  | NAMA MATA PELAJARAN    | GRUP                   |
|------|------------------------|------------------------|
| 1103 | BAHASA MELAYU          | B+ KEPULJIAN TERTINGGI |
| 1119 | BAHASA INGGERIS        | A+ CEMERLANG TINGGI    |
| 1225 | PENDIDIKAN MORAL       | A+ CEMERLANG TINGGI    |
| 1249 | SEJARAH                | A+ CEMERLANG TINGGI    |
| 1449 | MATHEMATICS            | A+ CEMERLANG TERTINGGI |
| 3472 | ADDITIONAL MATHEMATICS | A+ CEMERLANG TERTINGGI |
| 4531 | PHYSICS                | A+ CEMERLANG TINGGI    |
| 4541 | CHEMISTRY              | A+ CEMERLANG TERTINGGI |
| 4551 | BIOLOGY                | A+ CEMERLANG TERTINGGI |
| 6351 | BAHASA CINA            | A- CEMERLANG           |

Certified true copy of the original  
which was shown to me

1119(GCE-O) - 3B  
LAVAK MENDAPAT SIJIL

SENIOR ASSISTANT OF STUDENT AFFAIRS  
PENGARAH PEPERIKSAAN

**SAMPLE**

## Item No. 4 (STPM slip) – if applicable

Slip keputusan ini bukan sijil. Majlis Peperiksaan Malaysia berhak meminda butir-butir pada slip keputusan ini sebelum sijil dikeluarkan. Keputusan muktamad adalah seperti yang tercatat dalam sijil. Gred mata pelajaran adalah berdasarkan jumlah markah yang diperolehi dalam mata pelajaran berkenaan dan wajaran kertas.

Pencapaian bagi tiap-tiap kertas diberi gred A hingga F. Pencapaian pada peringkat lulus bagi tiap-tiap mata pelajaran diberi gred A hingga C, manakala pencapaian pada peringkat lulus sebahagian diberi gred C-, D+, dan D. Gred F menandakan calon gagal dalam mata pelajaran berkenaan. Lambang X menandakan calon tidak hadir sebahagian atau keseluruhan peperiksaan bagi mata pelajaran berkenaan.

Permohonan untuk menyemak semula keputusan peperiksaan dikenakan bayaran RM50.00 bagi satu kertas. Permohonan menyemak semula keputusan dan membetulkan butir-butir peribadi hendaklah sampai ke Majlis Peperiksaan Malaysia dalam tempoh dua minggu selepas pengumuman keputusan peperiksaan.

Permohonan penyemakan semula sama ada oleh calon sekolah atau calon persendirian individu hendaklah dihantar terus ke Majlis Peperiksaan Malaysia dan permohonan hendaklah dihadkan kepada keputusan yang jauh lebih rendah daripada yang dijangka. Majlis Peperiksaan Malaysia tidak akan mengeluarkan laporan prestasi calon.

Calon yang mendapat keputusan lulus penuh sekurang-kurangnya satu mata pelajaran akan dianugerahi sijil yang akan dikeluarkan seawal-lewalnya pada bulan Jun. Calon diberi tempoh masa 12 bulan selepas tarikh tersebut untuk mengambil sijil mereka. Selepas tempoh tersebut pihak sekolah atau Jabatan Pelajaran Negeri akan menghantar balik sijil-sijil yang tidak dituntut ke Majlis Peperiksaan Malaysia. Calon yang ingin mendapatkan sijilnya selepas tempoh tersebut hendaklah berurusan terus dengan Majlis Peperiksaan Malaysia dan akan dikenakan caj sebanyak RM50.00.

Ketua Eksekutif  
Majlis Peperiksaan Malaysia  
Persiaran 1, Bandar Baru Selayang  
68100 Batu Caves  
Selangor Darul Ehsan

Saya sahkan bahawa ini adalah salinan  
benar daripada surat/dokumen/sijil asal  
yang telah ditunjukkan kepada saya

Ketua Bidang Teknik & Vokasional  
SMJK  
Negeri Selangor Darul Ehsan.



### MAJLIS PEPERIKSAAN MALAYSIA KEPUTUSAN PEPERIKSAAN SIJIL TINGGI PERSEKOLAHAN MALAYSIA 2010

No. Sijil: 1159924

Nama :  
Angka Gilliran :  
No. Kad Pengenalan :  
Bilangan Mata Pelajaran Didaftarkan : 4

| MATA PELAJARAN    | WAJARAN % | GRED KERTAS | GRED MATA PELAJARAN | NILAI GRED MATA PELAJARAN |
|-------------------|-----------|-------------|---------------------|---------------------------|
| 900 PENGAJIAN AM  |           |             |                     |                           |
| PENGAJIAN AM 1    | 37.5      | A           | A                   | 4.00                      |
| PENGAJIAN AM 2    | 62.5      | A           |                     |                           |
| 954 MATHEMATICS T |           |             |                     |                           |
| MATHEMATICS T 1   | 50.0      | A-          | A-                  | 3.67                      |
| MATHEMATICS T 2   | 50.0      | A-          |                     |                           |
| 962 CHEMISTRY     |           |             |                     |                           |
| CHEMISTRY 1       | 30.0      | A           | A-                  | 3.67                      |
| CHEMISTRY 2       | 60.0      | A-          |                     |                           |
| CHEMISTRY 3       | 10.0      | A           |                     |                           |
| 964 BIOLOGY       |           |             |                     |                           |
| BIOLOGY 1         | 30.0      | A           | A-                  | 3.67                      |
| BIOLOGY 2         | 60.0      | A-          |                     |                           |
| BIOLOGY 3         | 10.0      | A           |                     |                           |

Ketua Eksekutif  
Majlis Peperiksaan Malaysia

- The documents attached for item 2 to 13 must be a “truly certified copy”.
- 第2至第13项之附件须是“核证影印本”。

- The documents attached for item 2 to 13 must be a “truly certified copy”.  
第2至第13项之附件须是“核证影印本”。

**Item No. 4 (Other equivalent qualifications) – if applicable**

**IARC College**  
TARU ABDEL KHALIM COLLEGE  
REGISTRY  
DIVISION OF EXAMINATIONS AND CREDIT ACCUMULATION

**ACADEMIC TRANSCRIPT**

Name: [REDACTED] Year of Admission: January 2008  
 Registration No: [REDACTED] School: SCHOOL OF SOC. SCIENCE & HUMANITIES  
 Identity Card No: [REDACTED] Date of Leaving/Graduation: March 2010  
 Sex: FEMALE  
 Programme: DIPLOMA IN MASS COMMUNICATION (PUBLIC RELATIONS)  
 Award Conferred: -  
 Remarks: Student has completed the programme and will be awarded the DIPLOMA IN MASS COMMUNICATION (PUBLIC RELATIONS) WITH MERIT of this College at the graduation ceremony to be held at a later date.

| Course Code   | Course Title                             | Grade | Credit Hours | Credit Earned | Quality Points |
|---|--|-------|--------------|---------------|----------------|
| Session: January 2008   |  |       |              |               |                |
| AACS1614  | INTRODUCTION TO INFORMATION TECHNOLOGY   | A     | 4.0          | 4.0           | 16.00          |
| AELE1023  | ENGLISH LANGUAGE                         | B     | 3.0          | 3.0           | 9.00           |
| AEMS2022  | HUMANAN ETHIK                            | A-    | 2.0          | 2.0           | 7.50           |
| AHMC1074  | INTRODUCTION TO MASS COMMUNICATION       | A-    | 4.0          | 4.0           | 15.00          |
| Total:  |  |       | 13.0         | 13.0          | 47.50          |
| GPA: 3.6538<br>CGPA: 3.6538<br>Total Credit Hours Earned : 13.0 |  |       |              |               |                |
| Session: May 2008   |  |       |              |               |                |
| AACS2614  | INTRODUCTION TO ELECTRONIC COMMERCE      | A     | 4.0          | 4.0           | 16.00          |
| AELE2263  | ENGLISH FOR COMMUNICATION                | B     | 3.0          | 3.0           | 9.00           |
| AEMS2042  | BAHASA MALAYSIA LANJUTAN                 | A-    | 2.0          | 2.0           | 7.50           |
| AHMC2114  | MALAYSIA: CULTURAL & RELIGIOUS PRACTICES | A-    | 4.0          | 4.0           | 15.00          |
| AHMC2924  | THE MODERN ELECTRONIC MEDIA              | B+    | 4.0          | 4.0           | 14.00          |
| ASCG1201  | SWIMMING (LEVEL 1)                       | S     | 1.0          | 1.0           | -              |
| ASCG2201  | SWIMMING (LEVEL 2)                       | S     | 1.0          | 1.0           | -              |
| Total:  |  |       | 19.0         | 19.0          | 61.50          |
| GPA: 3.6176<br>CGPA: 3.6333<br>Total Credit Hours Earned : 32.0 |  |       |              |               |                |
| Session: September 2008   |  |       |              |               |                |
| AACS1624  | INTRODUCTION TO ELECTRONIC PUBLISHING    | A     | 4.0          | 4.0           | 16.00          |
| AHMC1134  | CHINESE MODERN WRITING                   | B-    | 4.0          | 4.0           | 11.00          |
| AHMC2424  | PUBLIC RELATIONS                         | B+    | 4.0          | 4.0           | 14.00          |
| AHMC3054  | MASS MEDIA LAW                           | A-    | 4.0          | 4.0           | 15.00          |
| Total:  |  |       | 16.0         | 16.0          | 56.00          |
| GPA: 3.5000<br>CGPA: 3.5869<br>Total Credit Hours Earned : 48.0 |  |       |              |               |                |
| Session: March 2009   |  |       |              |               |                |
| AENS1412  | TAMADUN ISLAM DAN ASIA                   |       |              |               |                |

Salman Di Akui Sah

  
MAJISTRET  
MAHKAMAH MAJISTRET SEREMBAN



NO ALTERATIONS OR ERASURES

Campus: Jalan Genting Kelang, Setapak, 53300 Kuala Lumpur, Malaysia. Telephone: (6)03-4145 0100/23 http://www.tarc.edu.my  
 Postal Address: P.O. Box 10979, 50932 Kuala Lumpur, Malaysia. Fax: (6)03-4142 3166 Email: examination@mail.tarc.edu.my



- The documents attached for item 2 to 13 must be a “truly certified copy”.  
第2至第13项之附件须是“核证影印本”。

**Item No. 4 (Other equivalent qualifications) – if applicable**



**KOLEJ TUNKU ABDUL RAHMAN**  
拉曼學院

**TUNKU ABDUL RAHMAN COLLEGE**

Dengan ini disahkan bahawa  
茲証明  
It is hereby certified that

setelah tamat program yang diluluskan dan setelah memuakan Lembaga Pemeriksa telah dianugerahkan  
修業期滿成績及格准予畢業授予  
having duly completed the approved programme of study and having satisfied the Board of Examiners was awarded the

**DIPLOMA KOMUNIKASI MASSA  
(PERHUBUNGAN AWAM)  
dengan Kepujian**  
大眾傳播科文憑(公共關係學)(優等)  
**DIPLOMA IN MASS COMMUNICATION  
(PUBLIC RELATIONS)  
with Merit**

Salinan Di Akui Sah



MAJISTRET  
MAHKAMAH MAJISTRET SEREMBAN

Pengetua / 院長 / Principal

Ketua Sekolah / 校主任 / Head of School

Tarikh / 日期 / Date: **17 MARCH 2010**      Pendaftar / 註冊主任 / Registrar

DW08002360

**Item No. 5 (Academic Awards/Other Achievements)**

- The documents attached for item 2 to 13 must be a “truly certified copy”.  
第2至第13项之附件须是“核证影印本”。



## Item No. 6 (Testimonial and Record)

Sekolah Menengah **[REDACTED]**

Selangor Darul Ehsan, Malaysia.

### SURAT AKUAN

### TESTIMONIAL

Adalah diakui bahawa [REDACTED] Tingkatan [REDACTED]  
*This is to certify that* *Form*

Nombor Kad Pengenalan [REDACTED] Nombor Pendaftaran [REDACTED]  
*Identity Card Number* *Admission Number*

Tarikh lahir [REDACTED] Jantina Perempuan  
*Date of birth* *Sex*

adalah pelajar sekolah ini dari 2006 hingga 2010  
*was a student of this school from* *to*

Peperiksaan tertinggi diambil dan tahun SPM 2010  
*Highest examination taken and year*

#### A. Penilaian sahsiah ( Evaluation of character )

| Kepimpinan<br><i>Leadership</i> | Inisiatif<br><i>Initiative</i> | Tanggungjawab<br><i>Responsibility</i> | Keyakinan<br><i>Confidence</i> | Pergaulan<br><i>Sociability</i> | Kerjasama<br><i>Cooperation</i> | Keazaman<br><i>Perseverance</i> |
|---------------------------------|--------------------------------|--|--------------------------------|---------------------------------|---------------------------------|---------------------------------|
| A                               | A                              | A                                      | A                              | B                               | A                               | A                               |

A - Terbaik ( Excellent )      B - Baik ( Good )      C - Memuaskan ( Satisfactory )  
 D - Sederhana ( Average )      E - Tidak memuaskan ( Not Satisfactory )

#### B. Penilaian gerak kerja kokurikulum / Jawatan khas ( Assessment of co-curriculum activities / Significant responsibilities )

| BIL. | KEGIATAN   | JAWATAN / PENCAPAIAN | TAHUN       |
|------|--|----------------------|-------------|
| 1    | Lawatan ke Ben Odori                                   | Setiausaha           | 2010        |
| 2    | Persembahan Orkestra Cina Samping Hari Guru di SJK (C) | Penglibatan          | 2008        |
| 3    | Persatuan Bahasa Jepun                                 | Setiausaha           | 2010        |
| 4    | Konsert Pancaragam Muzik Oriental                      | Penglibatan          | 2010        |
| 5    | Program Rakan Muda Masyarakat Leadership 1Malaysia     | Penglibatan          | 2009        |
| 6    | Lawatan ke Japan Foundation, KL                        | Setiausaha           | 2009        |
| 7    | Lawatan Sambil Belajar ke Sushi King                   | Setiausaha           | 2010        |
| 8    | Pancaragam Muzik Oriental                              | Ahli Biasa           | 2006 - 2010 |
| 9    | Kem Motivasi Pancaragam Muzik Oriental                 | Penglibatan          | 2008        |
| 10   | Lawatan ke Trolak, Sungkai, Perak                      | Penglibatan          | 2010        |

Certified true copy of the original  
which was shown to me

Pengetua  
*Principal*

PENGETUA

Tarikh: 31/12/2010  
*Date*

SENIOR ASSISTANT OF STUDENT AFFAIRS

- The documents attached for item 2 to 13 must be a “truly certified copy”.  
第2至第13项之附件须是“核证影印本”。



## Item No. 6 (Testimonial and Record)

Sekolah Menengah [Redacted]

吉隆坡中華獨立中學

Selangor Darul Ehsan, Malaysia.

SIJIL BERHENTI SEKOLAH 离校证书 SCHOOL LEAVING CERTIFICATE

Nama : [Redacted] Tingkatan : 5  
 姓名 : [Redacted] 班级 : 5  
 No. Pendaftaran : [Redacted] Jantina : Perempuan  
 学号 : [Redacted] 性别 : 女性  
 No. Kad Pengenalan : [Redacted] Tarikh Lahir : [Redacted]  
 身份证号码 : [Redacted] 出生日期 : [Redacted]  
 No. Sijil Lahir : [Redacted] Tempat Lahir : [Redacted]  
 报生纸号码 : [Redacted] 出生地 : [Redacted]  
 Nama dan Alamat Sekolah Dahulu : SJK (C) [Redacted]  
 以前修业学校 : SJK (C) [Redacted]  
 Tarikh Masuk Sekolah : 03/01/2006 Tingkatan Mula Masuk : Tingkatan 1  
 入学日期 : 03/01/2006 入学年级 : 一年级  
 Nama Ibu bapa / Penjaga : [Redacted]  
 家长/监护人姓名 : [Redacted]  
 Tahun Peperiksaan : a) Penilaian Menengah Rendah (PMR) 2008  
 会考年份 : b) Sijil Pelajaran Malaysia (SPM) 2010  
 Kedatangan : [Redacted] Kelakuan : A  
 出席日数 : [Redacted] / 197 操行 : A  
 Jawatan Khas : [Redacted]  
 职位 : [Redacted]  
 (seperti Ketua Tingkatan, Pengawas dan lain-lain)  
 Kokurikulum :  
 课外活动  

| BIL | KEGIATAN   | JAWATAN     | TAHAP PENGLIBATAN |
|-----|--|-------------|-------------------|
| 1   | Lawatan ke Bon Odori                                   | Setiausaha  | Kebangsaan        |
| 2   | Persembahan Orkestra Cina Sempena Hari Guru di SJK (C) | Penglibatan | Daerah            |
| 3   | Persatuan Bahasa Jepun                                 | Setiausaha  | Sekolah           |
| 4   | Konsert PMO  | Penglibatan | Sekolah           |

 Tarikh Berhenti Sekolah : 31 Disember 2010  
 离校日期 : 31 Disember 2010  
 Sebab Berhenti : Tamat Persekolahan Tingkatan 5  
 离校原因 : 完成五年级学业  
 Catatan Khas : Seorang pelajar yang bersopan santun dan berbudi bahasa.  
 备注 : 一名举止文雅、彬彬有礼的学生。  
 CERTIFIED TRUE COPY OF THE ORIGINAL WHICH WAS SHOWN TO ME  
 SECRETARY OF STUDENT AFFAIRS

- The documents attached for item 2 to 13 must be a “truly certified copy”.  
 第2至第13项之附件须是“核证影印本”。

Pengetua 校长 ( )  
 Guru Tingkatan 班主任 ( )  
 Tarikh 日期 31/12/2010

- The documents attached for item 2 to 13 must be a “truly certified copy”.

第2至第13项之附件须是“核证影印本”。

第7项文件只需提交a、b、c或d的其中一张。惟以7a（EA表格）为首选。

For item 7, you are only required to submit either Doc 7a, b, c or d. However, preferably Doc 7a (EA Form).

(C.F. 8A - Pin. 2010) MALAYSIA **Penyata Gaji Pekerja SWASTA EA**

**CUKAI PENDAPATAN**  
PENYATA SARAAN DARIPADA PENGGAJIAN  
BAGI TAHUN BERAKHIR 31 DISEMBER 2010

No. Siri [REDACTED]  
No. Majikan E [REDACTED]

No. Cukai Pendapatan Pekerja [REDACTED]  
Cawangan LHDNM [REDACTED]

**BORANG EA INI PERLU DISEDIAKAN UNTUK DISERAHKAN KEPADA PEKERJA BAGI TUJUAN CUKAI PENDAPATANNYA**

**A BUTIRAN PEKERJA**

1. Nama Penuh Pekerja/Pesara (En./Cik/Puan) [REDACTED] 3. No. Kakitangan/No. Gaji [REDACTED]  
2. Jawatan [REDACTED]  
4. No. K.P. Baru [REDACTED]  
6. No. KWSP [REDACTED]  
7. Jika bekerja tidak genap setahun, nyatakan:  
(a) Tarikh mula bekerja [REDACTED]  
(b) Tarikh berhenti kerja [REDACTED]

**B PENDAPATAN PENGGAJIAN, MANFAAT DAN TEMPAT KEDIAMAN (Tidak Termasuk Elaun/Perkuisit/ Pemberian/Manfaat Yang Dikecualikan Cukai)**

|  | RM            |
|--|---------------|
| 1. Gaji kasar, upah atau gaji cuti (termasuk gaji lebih masa)<br>Fi (termasuk fi pengarah), komisen atau bonus<br>Tip kasar, perkuisit, penerimaan sagu hati atau elaun-elaun lain (Perihal pembayaran Cukai Pendapatan yang dibayar oleh Majikan bagi pihak Pekerja)  | [REDACTED] 00 |
| 2. Nilai Manfaat atau kemudahan berupa barangan:<br>(a) Kereta (Tarikh sebenar diperuntukkan (Jenis [REDACTED] Tahun [REDACTED] Model [REDACTED])) (i) Nilai kereta dan petrol<br>(b) Elektrik, air, telefon dan kemudahan lain (ii) Nilai pemandu<br>(c) Nilai manfaat rumahtangga: (Perabot yang tidak berkenaan)<br>(i) Sepanah lengkap dengan perabot/penyaman udara/langsir/permaidani, atau<br>(ii) Lengkap dengan perkakas dapur, pinggan mangkuk, peralatan atau perkakas, atau<br>(iii) Butiran berasingan: Perabot dan kelengkapan Perkakas dapur Hiburan dan rekreasi<br>(d) Pembantu rumah dan tukang kebun<br>(e) Manfaat tambang percutian<br>(f) Lain-lain (misalnya makanan dan pakaian) | [REDACTED]    |
| 3. Nilai tempat kediaman (Alamat [REDACTED])   | [REDACTED]    |
| 4. Bayaran balik daripada Kumpulan Wang Simpanan/Pencen yang tidak diluluskan  | [REDACTED]    |
| 5. Pampasan kerana kehilangan pekerjaan  | [REDACTED]    |

**C PENCEN DAN LAIN-LAIN**

1. Pencen  
2. Anuiti atau Bayaran Berkala yang lain

**JUMLAH** [REDACTED] 00

**D JUMLAH POTONGAN**

1. Potongan Cukai Bulanan (PCB) Tahun Semasa yang dibayar kepada LHDNM [REDACTED] 00  
2. Arahan Potongan CP 38 [REDACTED] PENOLONG KANAN HAL EHWAL MURID  
3. Potongan Zakat yang dibayar kepada pihak berkuasa pemungut zakat [REDACTED] SMJK [REDACTED]

**E CARUMAN YANG WAJIB DIBAYAR OLEH PEKERJA KEPADA KUMPULAN WANG PENCEN ATAU SIMPANAN YANG DILULUSKAN**

Nama Kumpulan Wang [REDACTED] SIMPANAN PEKERJA  
Amaun caruman yang wajib dibayar (nyatakan bahagian pekerja sahaja) RM [REDACTED] 00

**F BUTIRAN PEMBAYARAN TUNGGAKAN DAN LAIN-LAIN BAGI TAHUN-TAHUN TERDAHULU (SEBELUM TAHUN SEMASA)**

| Bayaran Bagi Tahun | Jenis Pendapatan | Jumlah Bayaran (RM) | Caruman KWSP (RM) | Potongan Cukai Bulanan (PCB) (RM) |
|--------------------|------------------|---------------------|-------------------|-----------------------------------|
| [REDACTED]         | [REDACTED]       | [REDACTED]          | [REDACTED]        | [REDACTED]                        |

**G JUMLAH ELAUN / PERKUISIT / PEMBERIAN / MANFAAT YANG DIKECUALIKAN CUKAI** RM [REDACTED]

Tarikh 25/02/2011

Nama Pegawai [REDACTED]  
Jawatan DIRECTOR  
Nama dan Alamat Majikan [REDACTED]

Saya sahkan bahawa ini adalah salinan yang benar daripada surat asal yang telah ditunjukkan kepada saya.

## Item No. 7b (Salary Slip – last 3 months) or

Staff Name: [REDACTED]  
I/C No: [REDACTED]  
EPF No: [REDACTED]  
Income Tax No: [REDACTED]  
Start on: [REDACTED]  
Last Day on: 30/11/2010

| Month       | Gross Salary | EPF        |            |            | Seswa      |            |            | Income Tax | Net Salary |
|-------------|--------------|------------|------------|------------|------------|------------|------------|------------|------------|
|             |              | E'yer      | E'yea      | Total      | E'yer      | E'yea      | Total      |            |            |
| January     | [REDACTED]   | [REDACTED] | [REDACTED] | [REDACTED] | [REDACTED] | [REDACTED] | [REDACTED] | [REDACTED] | [REDACTED] |
| February    | [REDACTED]   | [REDACTED] | [REDACTED] | [REDACTED] | [REDACTED] | [REDACTED] | [REDACTED] | [REDACTED] | [REDACTED] |
| March       | [REDACTED]   | [REDACTED] | [REDACTED] | [REDACTED] | [REDACTED] | [REDACTED] | [REDACTED] | [REDACTED] | [REDACTED] |
| April       | [REDACTED]   | [REDACTED] | [REDACTED] | [REDACTED] | [REDACTED] | [REDACTED] | [REDACTED] | [REDACTED] | [REDACTED] |
| May         | [REDACTED]   | [REDACTED] | [REDACTED] | [REDACTED] | [REDACTED] | [REDACTED] | [REDACTED] | [REDACTED] | [REDACTED] |
| June        | [REDACTED]   | [REDACTED] | [REDACTED] | [REDACTED] | [REDACTED] | [REDACTED] | [REDACTED] | [REDACTED] | [REDACTED] |
| July        | [REDACTED]   | [REDACTED] | [REDACTED] | [REDACTED] | [REDACTED] | [REDACTED] | [REDACTED] | [REDACTED] | [REDACTED] |
| August      | [REDACTED]   | [REDACTED] | [REDACTED] | [REDACTED] | [REDACTED] | [REDACTED] | [REDACTED] | [REDACTED] | [REDACTED] |
| September   | [REDACTED]   | [REDACTED] | [REDACTED] | [REDACTED] | [REDACTED] | [REDACTED] | [REDACTED] | [REDACTED] | [REDACTED] |
| October     | [REDACTED]   | [REDACTED] | [REDACTED] | [REDACTED] | [REDACTED] | [REDACTED] | [REDACTED] | [REDACTED] | [REDACTED] |
| November    | [REDACTED]   | [REDACTED] | [REDACTED] | [REDACTED] | [REDACTED] | [REDACTED] | [REDACTED] | [REDACTED] | [REDACTED] |
| December    | [REDACTED]   | [REDACTED] | [REDACTED] | [REDACTED] | [REDACTED] | [REDACTED] | [REDACTED] | [REDACTED] | [REDACTED] |
| Total       | [REDACTED]   | [REDACTED] | [REDACTED] | [REDACTED] | [REDACTED] | [REDACTED] | [REDACTED] | [REDACTED] | [REDACTED] |
| Bonus 2010  | [REDACTED]   | [REDACTED] | [REDACTED] | [REDACTED] | [REDACTED] | [REDACTED] | [REDACTED] | [REDACTED] | [REDACTED] |
| Final Total | [REDACTED]   | [REDACTED] | [REDACTED] | [REDACTED] | [REDACTED] | [REDACTED] | [REDACTED] | [REDACTED] | [REDACTED] |

Approved by

Employee signature

Saya sahkan bahawa ini adalah salinan yang benar daripada surat asal yang telah ditunjukkan kepada saya

PENOLONG KANAN HAL EHWAL MURID  
SMJK

- The documents attached for item 2 to 13 must be a “truly certified copy”.  
第2至第13项之附件须是“核证影印本”。

第7项文件只需提交a、b、c或d的其中一张。惟以7a（EA表格）为首选。

For item 7, you are only required to submit either Doc 7a, b, c or d. However, preferably Doc 7a (EA Form).

## Item No. 7c (BE Form) or

- The documents attached for item 2 to 13 must be a “truly certified copy”.

第2至第13项之附件须是“核证影印本”。

第7项文件只需提交a、b、c或d的其中一张。惟以7a（EA表格）为首选。

For item 7, you are only required to submit either Doc 7a, b, c or d. However, preferably Doc 7a (EA Form).

e-BE  
TAHUN TAKSIRAN  
2010

PEMASTAUTIN YANG TIDAK MENJALANKAN PERNIAGAAN  
(PENGEMUKAAN SECARA ELEKTRONIK)  
BORANG NYATA ORANG PERSEORANGAN (PEMASTAUTIN)  
DI BAWAH SEKSYEN 77 AKTA CUKAI PENDAPATAN 1967  
Borang ini ditetapkan di bawah seksyen 152 Akta Cukai Pendapatan 1967



Nama: [REDACTED] No. Cukai Pendapatan: [REDACTED]

**MAKLUMAT INDIVIDU**

Nama (seperti di kad pengenalan/pasport) [REDACTED]

No. Cukai Pendapatan [REDACTED]

No. KP Baru [REDACTED] No. Pasport Semasa [REDACTED]

Warganegara MALAYSIA Jantina PEREMPUAN

Status Pada 31-12-2010 [REDACTED] Tarikh Cerai [REDACTED]

Jenis Taksiran DIRI SENDIRI (BUJANG/JANDA/DUDA/SIMATI)

Ketetapan Umum Dipatuhi YA

Diluluskan oleh Menteri Sebagai Pekerja Berpengetahuan TIDAK Tarikh Diluluskan Oleh Menteri [REDACTED]

Alamat Surat-menyurat [REDACTED]

Poskod [REDACTED] Bandar [REDACTED]

Negeri SELANGOR

No. Telefon [REDACTED] No. Majikan E [REDACTED]

e-mel [REDACTED]

Nama Bank [REDACTED]

No. Akaun Bank [REDACTED]

Muka surat 1/7



- The documents attached for item 2 to 13 must be a “truly certified copy”.

第2至第13项之附件须是“核证影印本”。

第7项文件只需提交a、b、c或d的其中一张。惟以7a（EA表格）为首选。

For item 7, you are only required to submit either Doc 7a, b, c or d. However, preferably Doc 7a (EA Form).

## Item No. 7d (Salary Acknowledgement Letter)

April 5, 2011

TO WHOM IT MAY CONCERNED

Dear Sir/Madam

**RE: APPLICATION FOR SCHOLARSHIP.**

This is to certify that MS [REDACTED], mother to the above-mentioned student, has been employed as [REDACTED] Manager since [REDACTED] 2011, currently drawing a monthly salary of [REDACTED].

Kindly be informed.

Yours sincerely

For & on Behalf of [REDACTED]

[REDACTED]

Administration Manager

[REDACTED]

- The documents attached for item 2 to 13 must be a “truly certified copy”.

第2至第13项之附件须是“核证影印本”。

第7项文件只需提交a、b、c或d的其中一张。惟以7a（EA表格）为首选。

For item 7, you are only required to submit either Doc 7a, b, c or d. However, preferably Doc 7a (EA Form).

申请者家长若为自雇人士或没有报税的小贩，需到学校索取 Borang Pengesahan Pendapatan，以作为收入证明文件。

If the applicant's parents are self-employed or hawkers who have not filed income tax, required to obtain a Borang Pengesahan Pendapatan from school as proof of income.

## Item No. 7d (Salary Acknowledgement Letter)

### BORANG PENGESAHAN PENDAPATAN

(PENJAGA / PASANGAN PENJAGA)

NAMA : [REDACTED]  
NO. KAD PENGENALAN : [REDACTED]

| PENJAGA   |  | PASANGAN PENJAGA  |              |
|---|--|---|--------------|
| NAMA  | : [REDACTED]                                       | NAMA  | : [REDACTED] |
| NO. K / P   | : [REDACTED]                                       | NO. K / P   | : [REDACTED] |
| PERTALIAN   | : BAPA   | PERTALIAN   | : IBU        |
| PERKERJAAN  | : Penjaja  | PERKERJAAN  | : -          |
| PENDAPATAN  | : RM [REDACTED] sebulan<br>: RM [REDACTED] setahun | PENDAPATAN  | : -          |
| Dengan ini saya mengakui bahawa keterangan yang diberikan di atas adalah benar. |  | Dengan ini saya mengakui bahawa keterangan yang diberikan di atas adalah benar. |              |
| Tandatangan   |  | Tandatangan   |              |

### PENGESAHAN



## Item No. 8 (latest Electricity Bill – 1 month)

- The documents attached for item 2 to 13 must be a “truly certified copy”.  
第2至第13项之附件须是“核证影印本”。



**SYARIKAT BEKALAN AIR SELANGOR SDN. BHD.**  
(393257-T)

**BIL AIR**

| No. Akaun | Cagaran    | No. Bil |
|-----------|------------|---------|
| 30.00     | (SELANGOR) |         |

**NOTIS PEMOTONGAN**  
Akaun bekalan air tuam telah tertunggak. Sila jelaskan pembayaran dalam tempoh 14 hari bagi mengelakkan pemotongan.

| BIL    | Tarikh     | Bacaan   | Penggunaan |
|--------|------------|----------|------------|
| 650127 | 11-02-2011 | 55725489 | 21.2       |
| Ph0013 | 12-07-2010 | 221141   | 87.35      |

1R ANDA KLUJAHAN KAH!, GURAKAN ALI PENGHAI BIJAK.

| No. Meter    | Tarikh     | Bacaan | Penggunaan |
|--------------|------------|--------|------------|
| PUAS03A32577 | 11-02-2011 | 3809   | 10.72      |
|              | 11-02-2011 | 3778   | 12.57      |

| Keterangan Caj | Unit (m <sup>3</sup> ) | Kadar(RM) | Amaun (RM) |
|----------------|------------------------|-----------|------------|
| KEGUNAAN       | 20 x 29/31             | 0.57      | 10.72      |
| KEGUNAAN       | 12.20 x                | 1.03      | 12.57      |

|  |                        |        |
|--|------------------------|--------|
| <b>Kod Tarif:</b> 10                               | <b>Jenis Bacaan:</b> N |        |
| <b>Bil Semasa</b> : RM                             |                        | 21.23  |
| <b>Sila Jelaskan Bil Semasa Sebelum</b> 13-03-2011 |                        | RM     |
| <b>Tunggakan</b> : RM                              |                        | 60.95  |
| <b>Tunggakan Mesti Dijelaskan Dengan Segera</b>    |                        | RM     |
| <b>Baki Bil Bulan Lepas</b> : RM                   |                        | 21.98  |
| <b>BAYARAN AIR 20m<sup>3</sup> PERTAMA OLEH</b>    |                        | RM     |
| <b>KERAJAAN NEGERI SELANGOR</b>                    |                        | -10.72 |
| <b>Jumlah</b> : RM                                 |                        | 93.44  |
| <b>Pelarasn Penggenapan</b> : RM                   |                        | 0.01   |
| <b>Tambahan Cagaran</b> : RM                       |                        |        |
| <b>Jumlah Keseluruhan Yang Perlu Dibayar</b> : RM  |                        | 93.45  |

**JELASKAN BIL AIR, ELAKKAN PEMOTONGAN**



**SYARIKAT BEKALAN AIR SELANGOR SDN. BHD.**  
(393257-T)

**BIL AIR**

| No. Akaun | No. Bil  | Jumlah (RM) |
|-----------|----------|-------------|
| 30.00     | 55725489 | 93.45       |



11-02-2011

Talian Pusat Perkhidmatan Pelanggan (PUSPEL)  
Talian Bebas Tol: 1-800-88-5252

Saya sahkan bahawa ini adalah salinan yang benar daripada surat asal yang telah ditunjukkan kepada saya

**PENOLONG KANAN HAL EHWAL MURID**  
SMJK

## Item No. 9 (Latest Water Bill – 1 month)

- The documents attached for item 2 to 13 must be a “truly certified copy”.

第2至第13项之附件须是“核证影印本”。

**Item No. 9 (Latest Water Bill – 1 month)**

**TENAGA NASIONAL BERHAD (200966-W)**

|                    |         |       |                |          |
|--------------------|---------|-------|----------------|----------|
| NO. AKAUN PENGGUNA | KONTRAK | TARIF | Jumlah CAGARAN | NO. BIL  |
|                    |         | 013   | 240.00         | 26128501 |
|                    |         |       |                | RU 359   |

HARI TERBUKA UNITEN 26 Maf 2 11 (WWW.UNITEN.EDU.MY)

01300036838610
26128501

| KETERANGAN    | TARIKH     | JUMLAH | KOD | TARIKH KEMASUKAN |
|---------------|------------|--------|-----|------------------|
| BIL. AKHIR    | 10-02-2011 | 235.10 | N   | 09-03-2011       |
| BAYARAN AKHIR | 14-02-2011 | 235.10 |     |                  |

| CAJ                     | UNIT | KADAR | JUMLAH    |
|-------------------------|------|-------|-----------|
| BLOK KEGUNAAN ELEKTRIK  | 406  | 0.286 | RM 116.12 |
| JUMLAH BIL BULAN SEMASA |      |       | RM 116.12 |

|                  |      |      |                    |           |
|------------------|------|------|--------------------|-----------|
| PELBAGAI         | : RM | 0.00 |                    |           |
| PENALTI          | : RM |      | JUMLAH BIL         | RM 116.12 |
| TUNGGAKAN        | : RM | 0.00 | PENGGENAPAN        | RM -0.02  |
| CAGARAN TAMBAHAN | : RM | 0.00 | JUM. PERLU DIBAYAR | RM 116.10 |

| NO. JANGKA | DAHULU | KOD | SEMASA | KOD | KEGUNAAN | UNIT |
|------------|--------|-----|--------|-----|----------|------|
| K09925870  | 58009  | N   | 58505  | N   | 406      | kwh  |

Saya sahkan bahawa ini adalah salinan yang benar daripada surat asal yang telah ditunjukkan kepada saya

**PENOLONG KANAN HAL EHWAL MURID**  
SMJK

|   |                                     |        |            |           |    |
|---|-------------------------------------|--------|------------|-----------|----|
| TEK BACAAN DAHULU   | 10-02-2011                          | SEMASA | 10-03-2011 | BIL. HARI | 28 |
| NO. TEL ADUAN GANGGUAN BEKALAN:   | 15454                               |        |            |           |    |
| NO. TEL PERTANYAAN AM   | 1300885454                          |        |            |           |    |
| ALAMAT EMEL CRO   | : CRO-PETALINGJAYA@TNB.COM.MY       |        |            |           |    |
| NO. TIANG   | 72 JLN SELANGOR 46990 PETALING JAYA |        |            |           |    |
| MRIID:  | 0012                                |        |            |           |    |
| TUNGGAKAN PERLU DUELAHKAN SEBELUM BIL. SEMASA PERLU DUELAHKAN DALAM MASA 30 HARI (TAJU) SEBELUM | 09-04-2011                          |        |            |           |    |

11610

|                    |          |                      |
|--------------------|----------|----------------------|
| NO. AKAUN PENGGUNA | NO. BIL  | JUMLAH PERLU DIBAYAR |
|                    | 26128501 | 116.10               |



## Item No. 10 (Divorce Petition/Certificate)

5823354 6500499478 24/04/2014 11:44:02  
33-45-02/2014  
HD001.....300.0 X 1  
Jumlah RM\*\*\*\*\*300.00

LAMPIRAN NO : ]

DALAM MAHKAMAH TINGGI MALAYA DI JOHOR BAHRU

DALAM NEGERI JOHOR DARUL TAKZIM, MALAYSIA

PETISYEN PERCERAIAN NO: [REDACTED]-02/2014 TAHUN 2014

Dalam Perkara Seksyen 51 Akta Membaharui  
Undang-undang (Perkahwinan dan Perceraian),  
1976

[REDACTED]  
(NO K/P: [REDACTED]) ...Pempetisyen

[REDACTED]  
(NO K/P: [REDACTED]) ...Responden

DI HADAPAN PESURUHJAYA KEHAKIMAN  
GUNALAN M. MUNIANDY  
PADA 13 APRIL 2014

DALAM MAHKAMAH TERBUKA

DEKRI NISI  
(PERCERAIAN)

PETISYEN INI telah ditetapkan untuk perceraian di hadapan Yang Arif  
Pesuruhjaya Kehakiman dengan dihadiri oleh Pempetisyen dan Pn [REDACTED]  
[REDACTED] Peguamcara bagi pihak Pempetisyen

SETELAH MENELITI kertas-kertas kuasa dan SETELAH MENDENGAR  
peguamcara tersebut

MAKA PADA HARI INI DIDIKRIKAN bahawa perkahwinan yang dilangsungkan  
pada 25 Julai 1992 antara [REDACTED] (NO K/P : [REDACTED]) dan  
[REDACTED] (NO K/P: [REDACTED]) dibubarkan di bawah peruntukan  
Seksyen 51 Akta Membaharui Undang-Undang (Perkahwinan dan Perceraian)  
1976

SIN YEWOHM5KWM4M

\*\*Note : Serial number will be used to verify the originality of this document via eFILING portal

- The documents attached for item 2 to 13 must be a “truly certified copy”.  
第2至第13项之附件须是“核证影印本”。

## Item No. 11 (OKU Card)

- The documents attached for item 2 to 13 must be a “truly certified copy”.

第2至第13项之附件须是“核证影印本”。



## Item No. 12 (Death Certificate)



KERAJAAN MALAYSIA  
 GOVERNMENT OF MALAYSIA  
**CABUTAN YANG DIPERAKUI - SIJIL KEMATIAN**  
**CERTIFIED EXTRACTION - DEATH CERTIFICATE**



No. Dalam Register: **SB 100798**

Keedah-Kaedah Pendaftaran Kelahiran dan Kematian 1948 ( Kaedah 15 )  
 Birth and Death Registration Rules 1948 ( Rule 15 )

|   |   |
|---|---|
| Kawasan Pendaftaran<br>Registration Area<br><b>SABAH</b>  | Pusat Pendaftaran<br>Registration Centre<br><b>JPN INANAM</b> |
| <b>SIMATI / DECEASED</b>  |   |
| Nama Penuh<br>Full Name<br>[REDACTED]   |   |
| No. Kad Pengenalan<br>Identity Card No.<br>(H0000000)   | Umur<br>Age<br>TAHUN  |
| Jantina<br>Gender<br>LELAKI   |   |
| Jenis dan No. Dokumen Lain<br>Types and No. of Other Document<br>Maklumat Tidak Berkenaan   |   |
| Tarikh dan Waktu Kematian<br>Date and Time of Death<br>03 MEI 2011      07:45 AM  |   |
| keturunan<br>Race<br>CINA   | Tempat Kematian<br>Place of Death<br>[REDACTED]               |
| Alamat Terakhir<br>Last Address<br>[REDACTED]<br>88150 KOTA KINABANGA, SABAH  |   |
| <b>SEBAB DAN PENGESAH SEBAB KEMATIAN / CAUSE AND CERTIFIER THE CAUSE OF DEATH</b>   |   |
| Sebab Kematian<br>Cause of Death<br>UNDETERMINE   |   |
| Nama Pengesah<br>Name of Certifier<br>Maklumat Tidak Diperolehi   |   |
| No. Kad Pengenalan<br>Identity Card No.<br>Maklumat Tidak Diperolehi  |   |
| Jenis dan No. Dokumen Lain<br>Types and No. of Other Document<br>Maklumat Tidak Diperolehi  |   |
| <b>PEMAK LUM / INFORMANT</b>  |   |
| Nama<br>Name<br>[REDACTED]  |   |
| No. Kad Pengenalan<br>Identity Card No.<br>[REDACTED]   |   |
| Tarikh Pendaftaran<br>Date of Registration<br>03 MEI 2011   |   |
| Jenis dan No. Dokumen Lain<br>Types and No. of Other Document<br>Maklumat Tidak Berkenaan   |   |
| Disahkan bahawa maklumat di atas adalah seperti yang dicatat dalam Daftar Kematian.<br>Certified as a true extract from the Register of Deaths. |   |
| [Signature and Stamp Area]<br>[REDACTED]  |   |
| PENDAFTAR TOLAKU II<br>N. RAMADAN & HUSAINI BAKON<br>JPN INANAM<br>88100 KOTA KINABANGA   |   |

- The documents attached for item 2 to 13 must be a “truly certified copy”.  
 第2至第13项之附件须是“核证影印本”。

- The documents attached for item 2 to 13 must be a “truly certified copy”.

第2至第13项之附件须是“核证影印本”。

若申请者家庭的住所是租屋，请提供租约或月租收据文件证明。  
If the applicant's family lives in a rented house, please provide proof of the tenancy agreement or monthly rental receipt.

A TENANCY AGREEMENT made this **1<sup>st</sup> day of December, 2020** between [REDACTED] (NRIC NO: [REDACTED]) of [REDACTED] *Selangor* (hereinafter referred to as “**the Landlord**”) of the one part and [REDACTED] (NRIC NO: [REDACTED]) (hereinafter referred to as “**the Tenant**”) of the other part.

WHEREAS **Item No. 13 (Tenancy Agreement)**

- I. The Landlord is the owner of the double storey house known as [REDACTED], [REDACTED] Selangor (hereinafter referred to as “**the said Premises**”).
- II. The Landlord has agreed to let and the Tenant has agreed to rent the said Premises at a monthly rental of **Ringgit Malaysia [REDACTED]** only payable in advance with effect from the **1<sup>st</sup> day of December, 2020** for a period of **Two (2) years** upon terms and conditions hereinafter appearing.
- III. Upon the expiration of the agreement, the Tenant shall be given the option to renew the agreement for another **One (1) year** at a revised rental in which the quantum of adjustment to be agreed by both parties shall not exceed **Twenty Five Percent (25%)** of the current rental. This renewal option shall become null and void if the rental rate cannot be agreed by both parties within thirty (30) days and the Landlord shall thereafter be entitled to vacant possession of the said Premise. The existing rental at the time subject in all other respect to the same conditions and covenants as are herein contained save and except this clause for the renewal of this tenancy.
- IV. The Tenant shall not sub-let any part of the said Premises to any other parties without the permission from the Landlord.

WHEREBY IT IS AGREED as follows:

1. The Landlord lets and Tenant rents the said Premises for a period of **Two (2) years** commencing from the **1<sup>st</sup> day of December, 2020** and terminating on the **30<sup>th</sup> day of November, 2022** at a monthly rental of **Ringgit Malaysia [REDACTED]** only payable in advance on the 1<sup>st</sup> day of each succeeding month. The first payment shall be made upon the execution of this Agreement.
2. The Tenant shall also on signing of this Agreement pay a sum of **Ringgit Malaysia [REDACTED]** only being **One (1) month deposit** and

tenancy 2020